

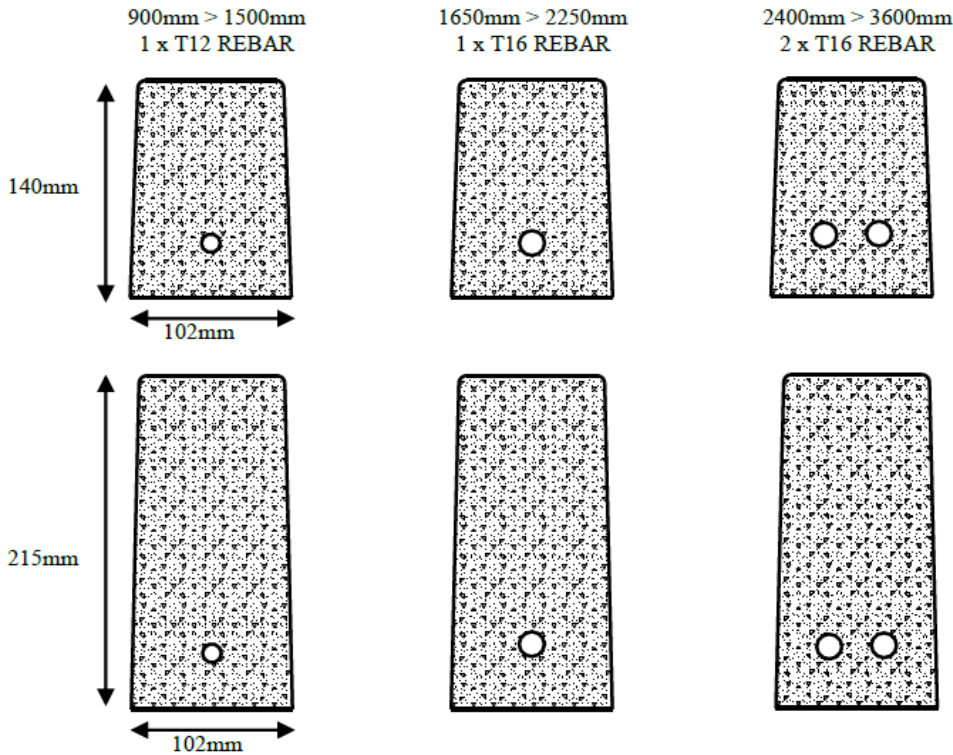

Precast Lintol Load Tables

41a Pomeroy Road Dungannon Co Tyrone N.Ireland BT70 3AZ
 Tel: 0044 (0)28 87761313 Email: info@tullyleek.co.uk



- Material Data**
- Concrete Grade (min) 50N/mm²
 - Density 2360kg/m³
 - Water/Cement (max) 0.55
 - Cement Type CEM1 42.5
 - Cement Content (min) 300kg/m³
 - Steel Reinforcement Grade 460 (BS4449)
 - Cover to Steel 30mm
 - Fire Resistance 1.5 Hours
 - Exposure Classes XO, XC1, XC2, DC1
 - Aggerate BS882

Lintol Type 100 x 140mm

Cover = 30 mm
 FCU = 50N/mm²

Overall Length	Span Clear Span	SUDIL (kN)
450	150	34.8
600	300	23.2
750	450	17.3
900	600	13.8
1050	750	11.4
1200	900	9.7
1350	1050	9.4
1500	1200	9
1650	1350	10.8
1800	1500	10.8
1950	1650	10.8
2100	1800	10.7
2250	1950	13.4
2400	2100	12.9
2550	2250	11.3
2700	2400	10.1

Lintol Type 100 x 215mm

Cover = 30 mm
 FCU = 50N/mm²

Overall Length	Span Clear Span	SUDIL (kN)
600	150	99.8
750	300	59.8
900	450	42.7
1050	600	33.1
1200	750	27
1350	900	25.5
1500	1050	22
1650	1200	23.1
1800	1350	20.5
1950	1500	18.5
2100	1650	16.7
2250	1800	17.7
2400	1950	16.7
2550	2100	16.7
2700	2250	16.6
2850	2400	16.5
3000	2550	16.5
3150	2700	16.4
3300	2850	16.3
3450	3000	16.3
3600	3150	16.2

SUDIL = Safe Uniformly Distributed Imposed Load (kN)